

**NASFAA**  
 July 6-9, 2008  
 DISNEY SWAN and DOLPHIN HOTEL  
 ATLANTIC HALL A & B  
 LAKE BUENA VISTA , FL

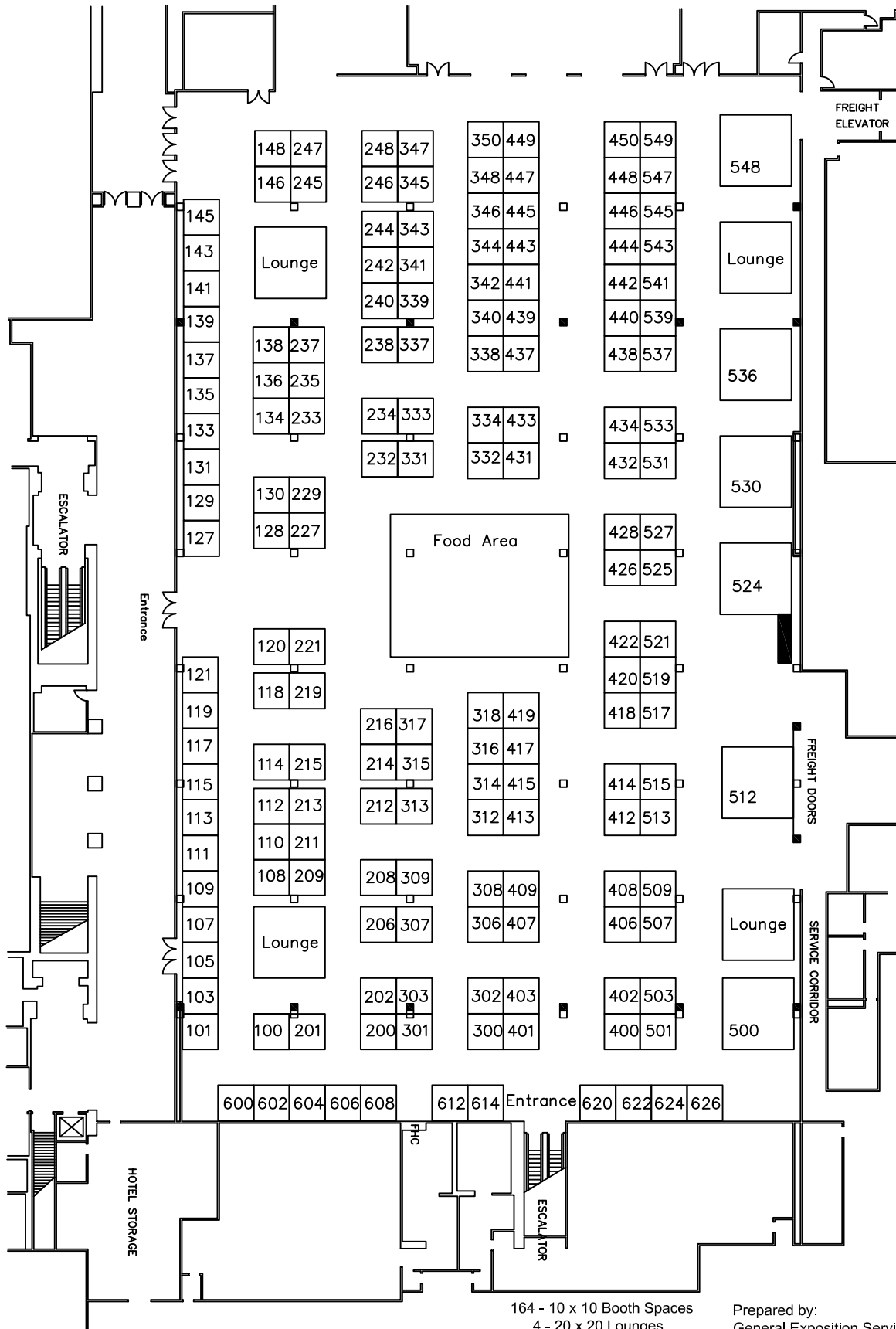

164 - 10 x 10 Booth Spaces  
 4 - 20 x 20 Lounges  
 6 - 20 x 20 Islands

Prepared by:  
 General Exposition Services, Inc.  
 info@generalexposition.com  
 610-495-8866 FAX 610-495-8870  
 1-4-08 LC

Please note: Every effort has been made to ensure the accuracy of all the information contained on the floorplan. However, no warranties are made with respect to this floorplan. If the location of building columns, utilities or other architectural components of the building is a factor in the construction or usage of an exhibit, it is the sole responsibility of the exhibitor to physically inspect the facility to verify all dimensions and locations.