

2015 NASFAA NATIONAL CONFERENCE SCHEDULE AT A GLANCE

session type

- P Peer to Peer Session
- H Half-Day Workshop
- F Financial Aid Business Solutions Seminar

session tracks

- Leadership & Communication
- Compliance
- U.S. Department of Education
- Enrollment & Retention (Admissions)
- Research
- Graduate/Professional Issues

| | Strand 10AB - Level 2 | Strand 11AB - Level 2 | Celestin GH - Level 3 | Strand 13AB - Level 2 | Celestin F - Level 3 | Strand 12AB - Level 2 | Celestin E - Level 3 | Celestin D - Level 3 | Celestin A - Level 3 | Celestin BC - Level 3 | Strand 1 - Level 2 | Strand 7 - Level 2 | |
|------------------------------|---|--|---|---|--|--|--|------------------------------|------------------------------------|--|--|---|--|
| Sunday July 19 | 10:00am - 11:00am | First-Time Conference Attendees' Kick-Off Networking Event (Celestin BC - Level 3) | | | | | | | | | | | |
| | 10:30am - 11:45am | Sector Caucuses (see detailed schedule for room assignments) | | | | | | | | | | | |
| | 12:45pm - 2:15pm | Opening Session with Featured Speaker Hill Harper (Empire Ballroom - Level 2) | | | | | | | | | | | |
| | 2:30pm - 3:30pm | NASFAA Management Benchmarking Task Force | It's All in the Game! | Making Determinations of Unaccompanied Homeless Youth Status | A Collective and Pioneering Methodology to Student Financial Literacy | Student Loan Repayment Through Employer Withholding | Innovative New Programs-How to Remain in Compliance in a Changing Landscape | R2T4 - Credit Hour Programs | Federal Town Hall | From "Schoolhouse Rock" to IFAP | | | F AwardSpring: A Better Way to Manage Your Scholarships |
| | 3:45pm - 4:45pm | Examining Trends & Solutions in Administrative Burden | | | Communicating Value vs. Price - Why Transparency is Key | Innovative Strategies for Diversity in the Financial Aid Office | Federal Update on HRSA's Title VII and VIII - Student Loans and Scholarships | R2T4 - Module Programs | Verification for 2016-17 | Award Letters: Decoding with Students and Families | | F SoFi: Student Loan Refinancing 101 | |
| 4:45pm - 6:30pm | Welcome Reception & Exhibit Hall Opening (Elite Hall - Level 1) | | | | | | | | | | | | |
| Monday July 20 | 7:30am - 8:45am | Past Presidents & National Chairs Networking Breakfast (Strand 5 - Level 2) | | | | | | | | | | | |
| | 8:00am - 8:45am | Graduate & Professional Institutions' Networking Breakfast (Imperial 5AB - Level 4) | | | | | | | | | | | |
| | 8:00am - 8:45am | Continental Breakfast (Elite Hall - Level 1) | | | | | | | | | | | |
| | 8:00am - 12:30pm | Exhibit Hall Open (Elite Hall - Level 1) | | | | | | | | | | | |
| | 9:00am - 10:00am | General Session - Yes or No? Student Loans Are a Crisis For Students and the Economy (Empire Ballroom - Level 2) | | | | | | | | | | | |
| | 10:15am - 11:15am | NSLDS Update | The Big Idea in Student Aid: NASFAA's Policy Challenge | New Research and College-Level Policies to Help Students Borrow Responsibly | Leveraging Financial Aid to Expand Student Opportunities | Innovative Tools to Enhance Your NASFAA Membership Experience | The Future of PSLF: Recommendations, Reauthorization, and Beyond | Gainful Employment | Federal Town Hall | H NASFAA U - Professional Judgment | H Ethics and Financial Aid: Right or Wrong | F Student Self-Service: The Future of Financial Aid | F AwardSpring: A Better Way to Manage Your Scholarships |
| | 11:30am - 12:30pm | Privacy and Data Protection | Examining NCAA Rule Changes and Cost of Attendance | Minimizing Liabilities in an ED Program Review | Working with Undocumented Students: Deferred Action for Childhood Arrivals | Leveraging Analytics to Drive Financial Aid Counseling Strategy | Educating the Department of Education and Congress About Graduate Education | Gainful Employment | Consumer Information Requirements | | | F The Redesigned SAT and Financial Aid | |
| | 12:45pm - 2:15pm | Luncheon with Featured Speaker Justin Draeger | | | | | | | | | | | |
| | 2:15pm - 5:30pm | Exhibit Hall Open (Elite Hall - Level 1) | | | | | | | | | | | |
| | 3:15pm - 4:15pm | Verification for 2016-17 | NCAA - An Update on Division I Financial Aid Legislation | Two Loan Disbursements + Midterm Grades = Increase in Student Success! | Helping Students Make Good Financial Decisions | | Financial Literacy - Grad Students: Highly Intelligent v. Financially Savvy | COD Update | Consumer Information Requirements | Holistic Campus Solutions- Collaborating Towards Student Retention & Success | P The Many Hats and Faces of a Director | F AcademicWorks: Comprehensive Scholarship Management Solution | F Best Practices for Improving Your Cohort Default Rate |
| 4:15pm - 5:30pm | Un-Wined-Hour (Elite Hall - Level 1) | | | | | | | | | | | | |
| 6:30pm | NASFAA's 50th Anniversary Kick-Off Parade (Meet in Hyatt Lobby) | | | | | | | | | | | | |
| Tuesday July 21 | 7:30am - 8:45am | Regional & State Presidents Breakfast (Strand 5 - Level 2) | | | | | | | | | | | |
| | 8:00am - 8:45am | Continental Breakfast (Elite Hall - Level 1) | | | | | | | | | | | |
| | 8:00am - 11:15am | Exhibit Hall Open (Elite Hall - Level 1) | | | | | | | | | | | |
| | 9:00am - 10:00am | Simplifying R2T4: Findings from NASFAA's Task Force | Evaluating & Reporting the Effectiveness of Online Communication w/Students | R2T4 & Modules: Navigating the New Regulations from the Campus Perspective | Walking the Path: Behavioral Finance to Strengthen Financial Ed Outcomes | NASFAA's Peer Review Program: Like An Audit But w/Empathy & Advice | Graduate/Professional Town Hall Meeting | COD Update | 150% Direct Subsidized Loan Limits | H Financial Aid Issues in a Competency-Based Education Model | P Financial Aid Tool Box - A-Z | F Award Letters that Don't Suck | |
| | 10:15am - 11:15am | State Authorizations | The Reward for Doing a Good Job is More Work! | Improving the Campus-Based Aid Allocation Formula | Reflecting a Changing Society: Diversity in the Hiring Process | It's Not Just About Equity Anymore! | Improving Student Solutions from Federal Policy Change | 150% - A Life Cycle Overview | 150% Direct Subsidized Loan Limits | | P Impact of Award Displacement on Students: Mitigating Practices & Solutions | F SoFi: Student Loan Refinancing 101 | F Best Practices for Improving Your Cohort Default Rate |
| | 11:30am - 1:30pm | Awards Luncheon & Annual Business Meeting (Empire Ballroom - Level 2) | | | | | | | | | | | |
| | 1:30pm - 4:15pm | Exhibit Hall Open (Elite Hall - Level 1) | | | | | | | | | | | |
| | 1:45pm - 2:45pm | State Authorizations | Compliance Officer: Do You Need Me? | A Financial Aid Director's Guide to Trending Legal Issues | How to Say No: Improving Responses to Award Appeals | Encouraging Good Behavior: Lowering Defaults Through Early Consumer Info | FAFSA Simplification: Finding the Right Way | 150% - A Life Cycle Overview | Repayment Plans | H NASFAA U - Cost of Attendance | H Leading Up, Down and All Around | F Joining Forces to Deliver Student Opportunity | |
| 3:00pm - 4:00pm | Program Review Essentials & Top 10 Compliance Findings | Hiring, Training and Promoting the Emerging Leaders | Tune Up Your Compliance - Part Deux | The State University of New York's Approach to Student Retention | Advanced Techniques in Social Media | Legislative Update from the Graduate and Professional Perspective | Federal Town Hall | Repayment Plans | | | F AcademicWorks: Comprehensive Scholarship Management Solution | | |
| 4:15pm - 5:15pm | Inside the Beltway: NASFAA Federal Update | Happy Staff, Happy Life | Title IV, Veterans & Military Benefits Administration at a Crossroads | Responsible Borrowing Initiatives | Reviewing the Results of the Loan Servicing Issues Task Force | Graduate/Professional Orientation Changing Practices | NSLDS Update | Verification for 2016-17 | | | | | |
| Wednesday July 22 | 8:30am - 11:00am | Closing Breakfast and General Session (Empire Ballroom - Level 2) | | | | | | | | | | | |



NASFAA Shuttle Service

Shuttles will provide service from all official hotels to and from the Hyatt Regency New Orleans. Hotels include the Holiday Inn New Orleans - Superdome, La Pavillon, Homewood Suites New Orleans and Intercontinental New Orleans.

Sunday, July 19
 8:00am – 12:30pm – every 15 minutes
 12:30pm – 4:45pm – every 30 minutes
 4:45pm – 7:00pm – every 15 minutes

Monday, July 20
 7:00am – 9:00am – every 15 minutes
 9:00am – 4:45pm – every 30 minutes
 4:45pm – 6:00pm – every 15 minutes

Tuesday, July 21
 7:00am – 9:00am – every 15 minutes
 9:00am – 4:00pm – every 30 minutes
 4:00pm – 5:45pm – every 15 minutes

Wednesday, July 22
 7:30am – 11:30am – every 15 minutes

Meeting space floor plans

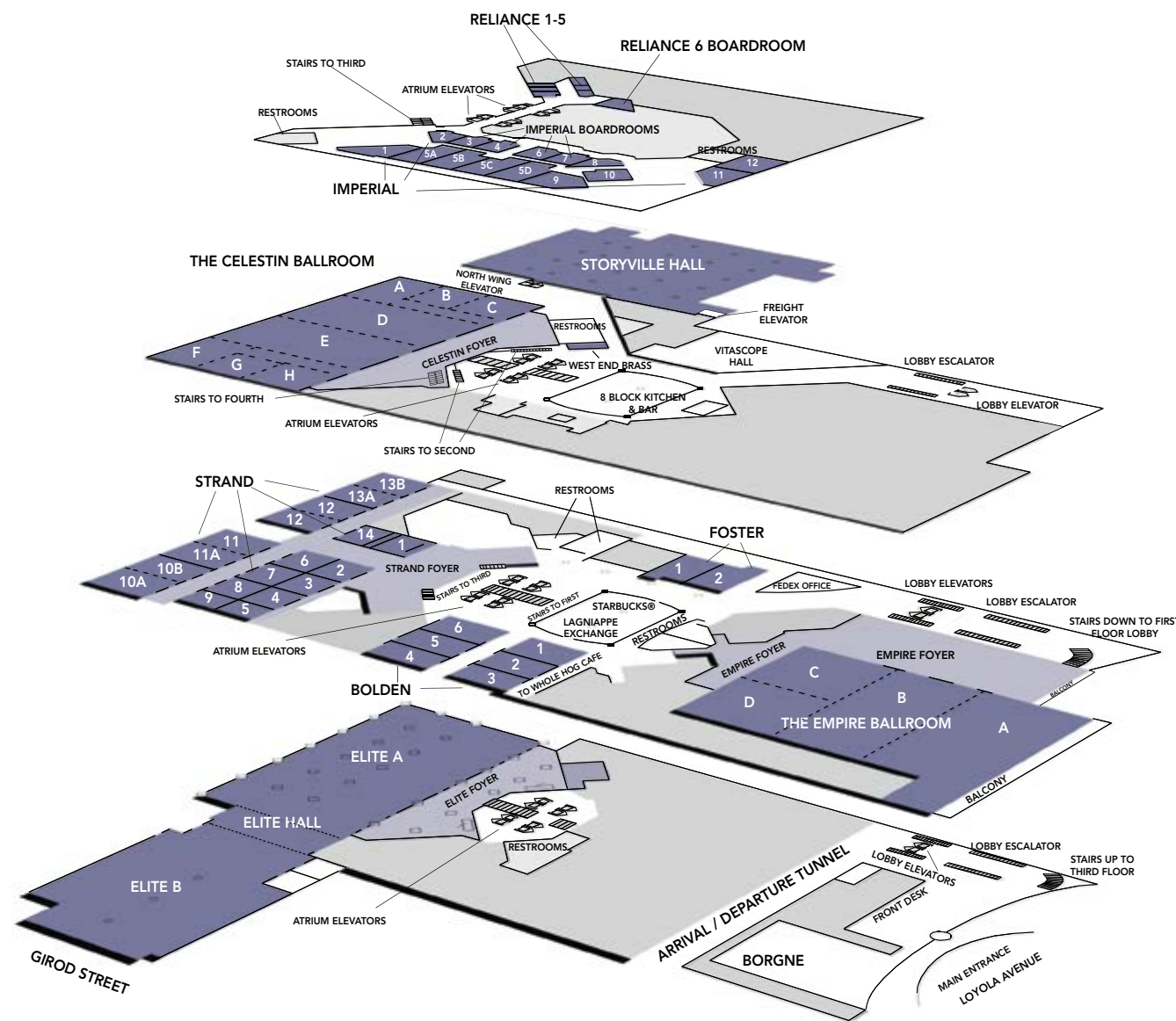

Level one

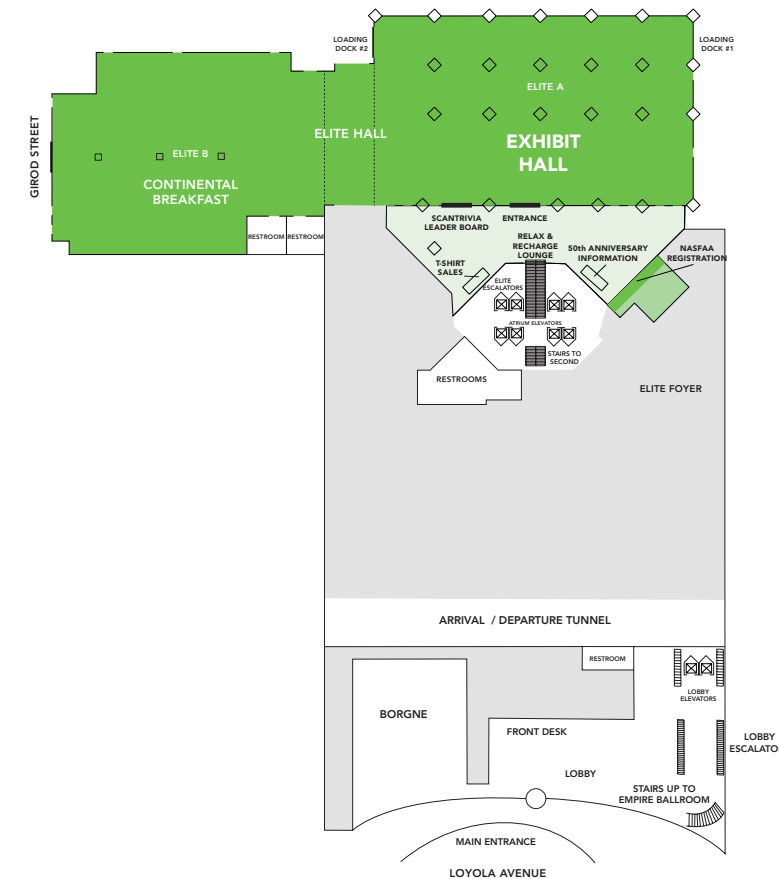

Level two



Level three



Level four

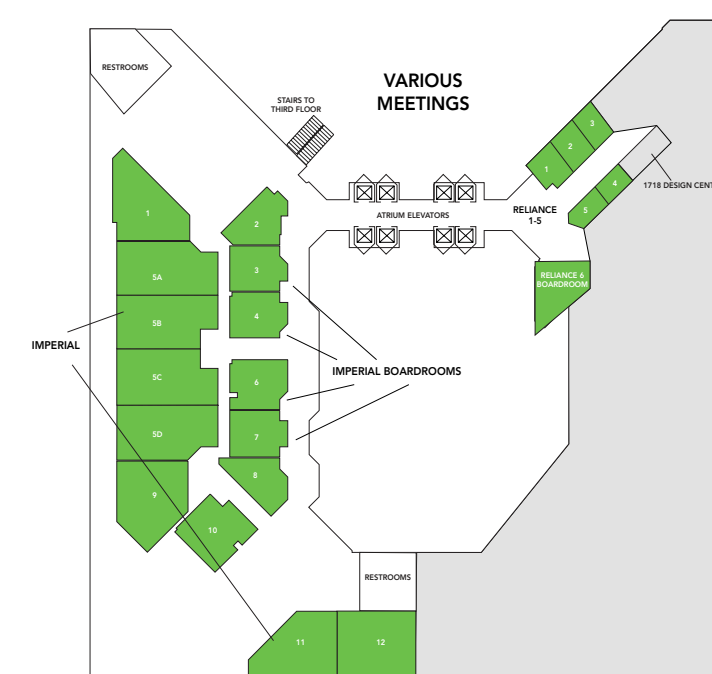

2015 conference
Schedule at-a-glance
 JULY 19-22 ★ NEW ORLEANS, LA



connect in New Orleans!
 NASFAA and Inceptia are providing free WiFi!

You may access the Hyatt Regency New Orleans WiFi network for business use in the meeting space area.

This service is sponsored by Inceptia.

SSID: NASFAA15
Encryption Key: inceptia

